

FWD FIT

FWD fit

Polyamide fitting manufacture



W: <https://fwdfit.com/>

E: info@fwdfit.com

Phone: +38 093 327 6430

Telegram: +38 093 327 6430

FORWARD FIT



Universal polyamide connecting fittings ***Forward fit*** let you create any possible communication layout easily and quickly. PA fittings usage eliminates the need of qualified personnel, especially welders and turners. This option is extremely important for drip irrigation systems. PA fittings have a number of significant advantages over metal ones, such as total chemical resistance, corrosion resistance, no need for a renewed paint coating, units and components have low weight and cost.

Application area of ***Forward fit*** technology contains drip irrigation systems, water supply systems and other pipeline networks.

FORWARD FIT ADVANTAGES:

- Units' low cost
- Doesn't have annual maintenance cycles typical for metal units, such as painting and rust removal.
- Final units' low weight reduces logistics costs. Loading and unloading operations can be carried out manually, special cargo equipment isn't required. The risk of industrial injuries is also reduced
- Fast assembly and disassembly
- Long service life
- Corrosion resistance
- Ultraviolet radiation resistance
- Chemical resistance
- Low requirements for inter-season storage conditions, possible to store in agrochemical warehouses and in the open air
- Compact inter-season storage
- High operating pressure (15 kg/cm²)
- Strict unification and suitable accounting.
- Versatility of fasteners (DIN 2576)
- Environmental friendly (the product can serve for decades, pure recyclable polymer)

PRODUCT CATALOG

Flanged 4-way cross 6"



Flanged tee 6"



Flanged Elbow 6"



Flanged Concentric Reducer 6" to 4"



FWD FIT

Flanged tee 4"



Flange 6" with barb 6"



Flange 4" with barb 4"



Threaded flange 4" for pressure regulator 4"



Threaded flange 4"



Barb 6"



Barb 4"



Blind flange 4"



Rubber gasket for flange 4"

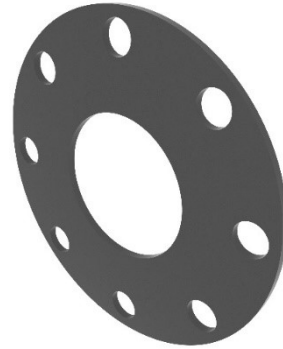

Rubber gasket for flange 6"

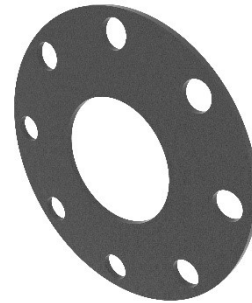

O-ring 75x3.0 mm

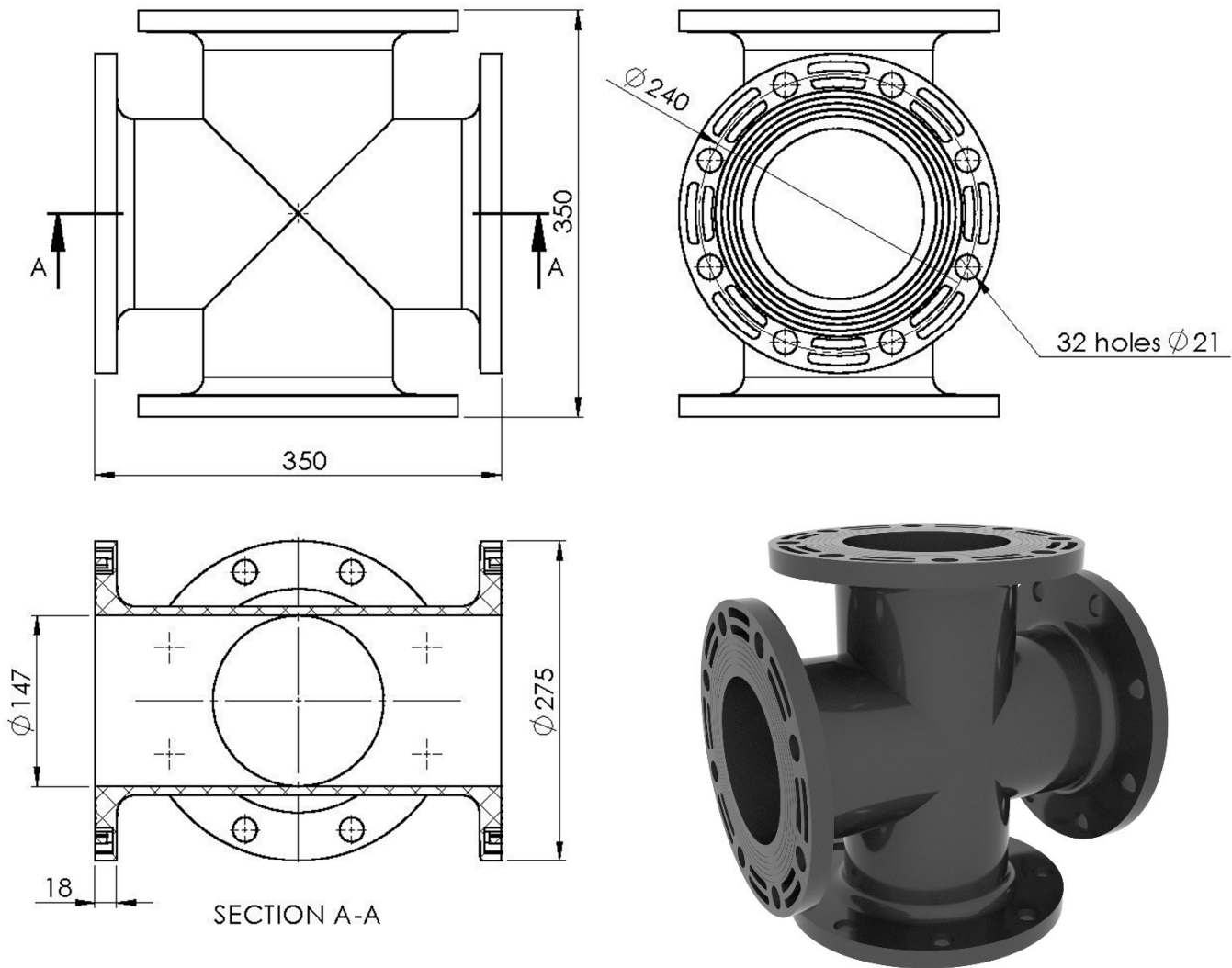

FORWARD FIT Flanged 4-way cross 6"

Basic element. Usually, the start point of the connection unit assembly. Flanges 6" let the element connect to the existing pipeline or to another *FORWARD FIT* fitting. Any type of wafer shut-off valves 6" is allowed.

Матеріал:	склонаповнений поліамід.
Граничний тиск:	40 кг/см ²
Робочий тиск:	15 кг/см ²

FORWARD FIT Flanged tee 6"

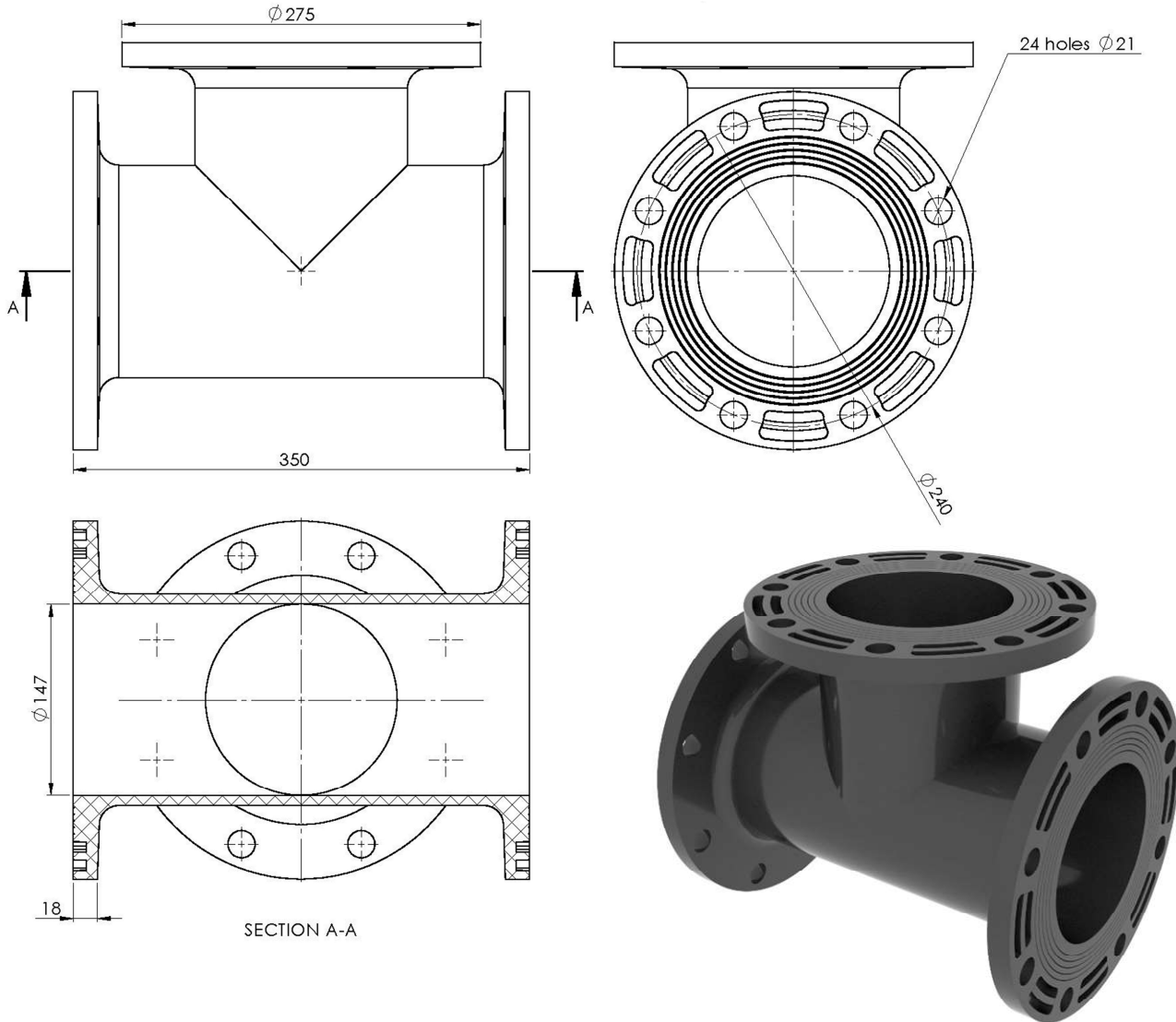

Basic element. Usually, the start point of the connection unit assembly. Flanges 6" let the element connect to the existing pipeline or to another *FORWARD FIT* fitting. Any type of wafer shut-off valves 6" is allowed.

Material:	glass-filled polyamide
Operating pressure limit:	40 kg/cm ²
Operating pressure:	15 kg/cm ²

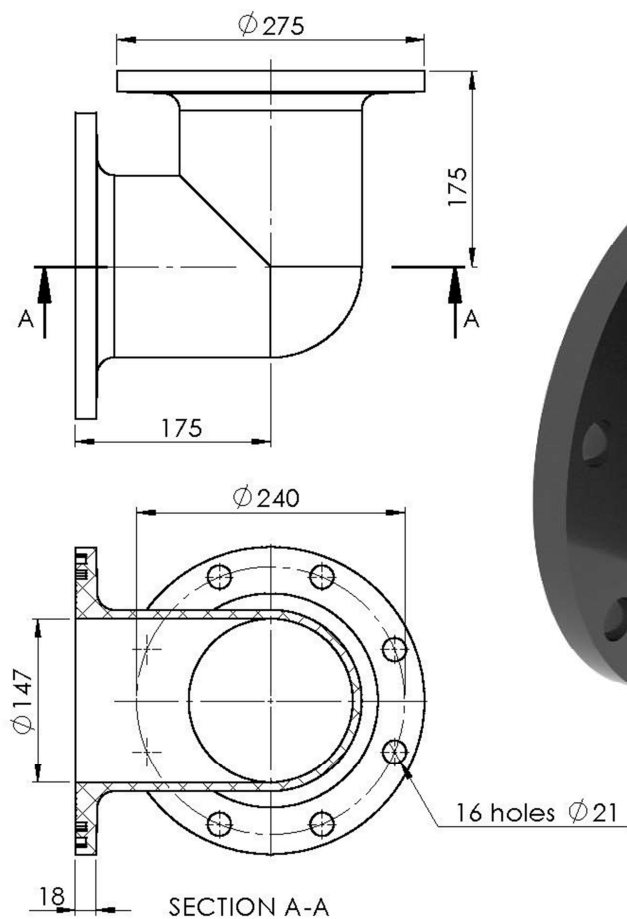
FORWARD FIT Flanged elbow 6"

Basic element of the connection unit. Flanges 6" let the element connect to the existing pipeline or to another *FORWARD FIT* fitting. Any type of wafer shut-off valves 6" is allowed.

Material:	glass-filled polyamide
Operating pressure limit:	40 kg/cm ²
Operating pressure:	15 kg/cm ²

FORWARD FIT Flanged Concentric Reducer 6" to 4"

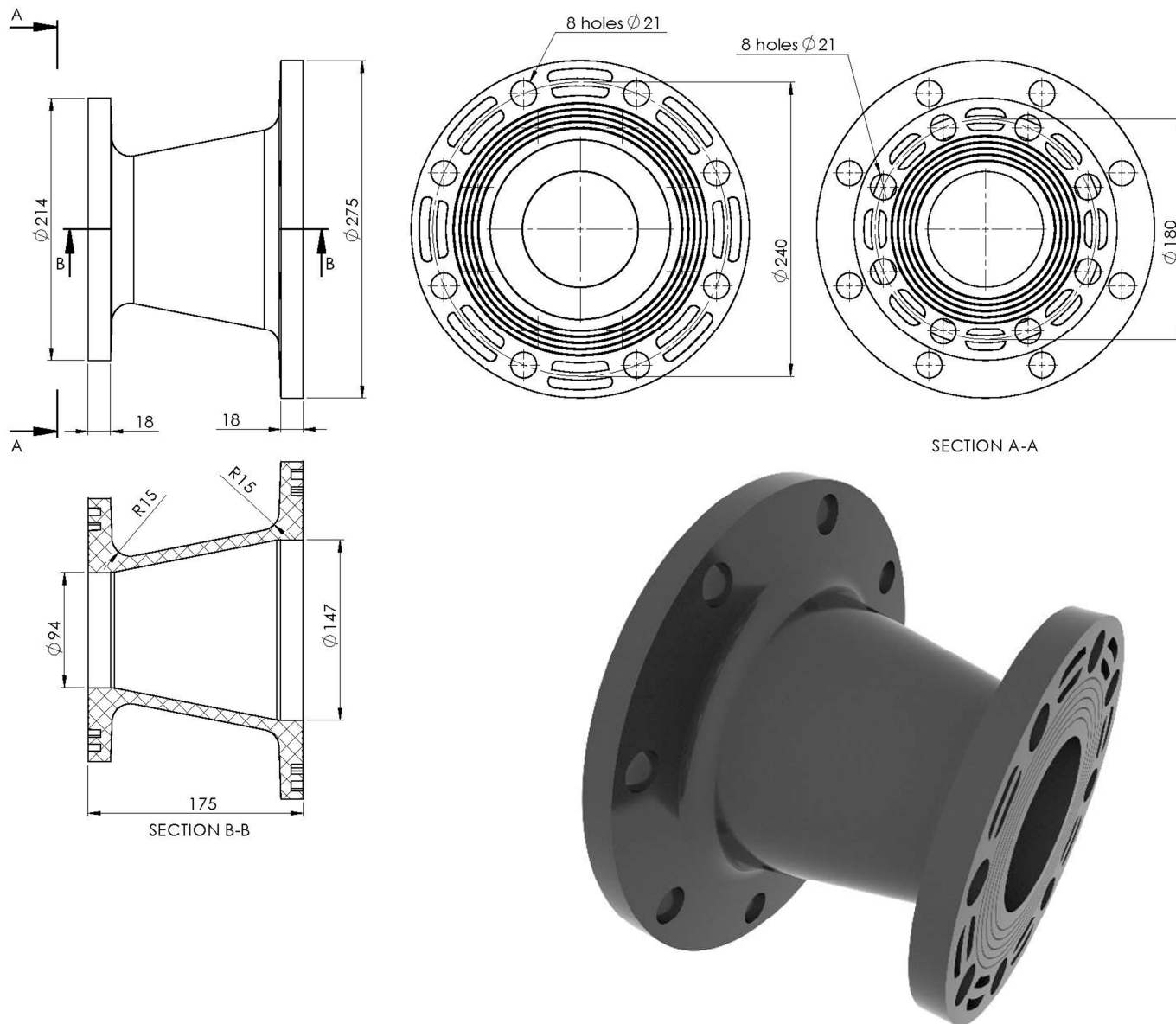

Basic element of the connection unit. Allows the pipeline transition between 6" and 4" diameters. Flanges 6" and 4" let the element connect to the existing pipeline or to another *FORWARD FIT* fitting. Any type of wafer shut-off valves 6" and 4" is allowed.

Material:	glass-filled polyamide
Operating pressure limit:	40 kg/cm ²
Operating pressure:	15 kg/cm ²

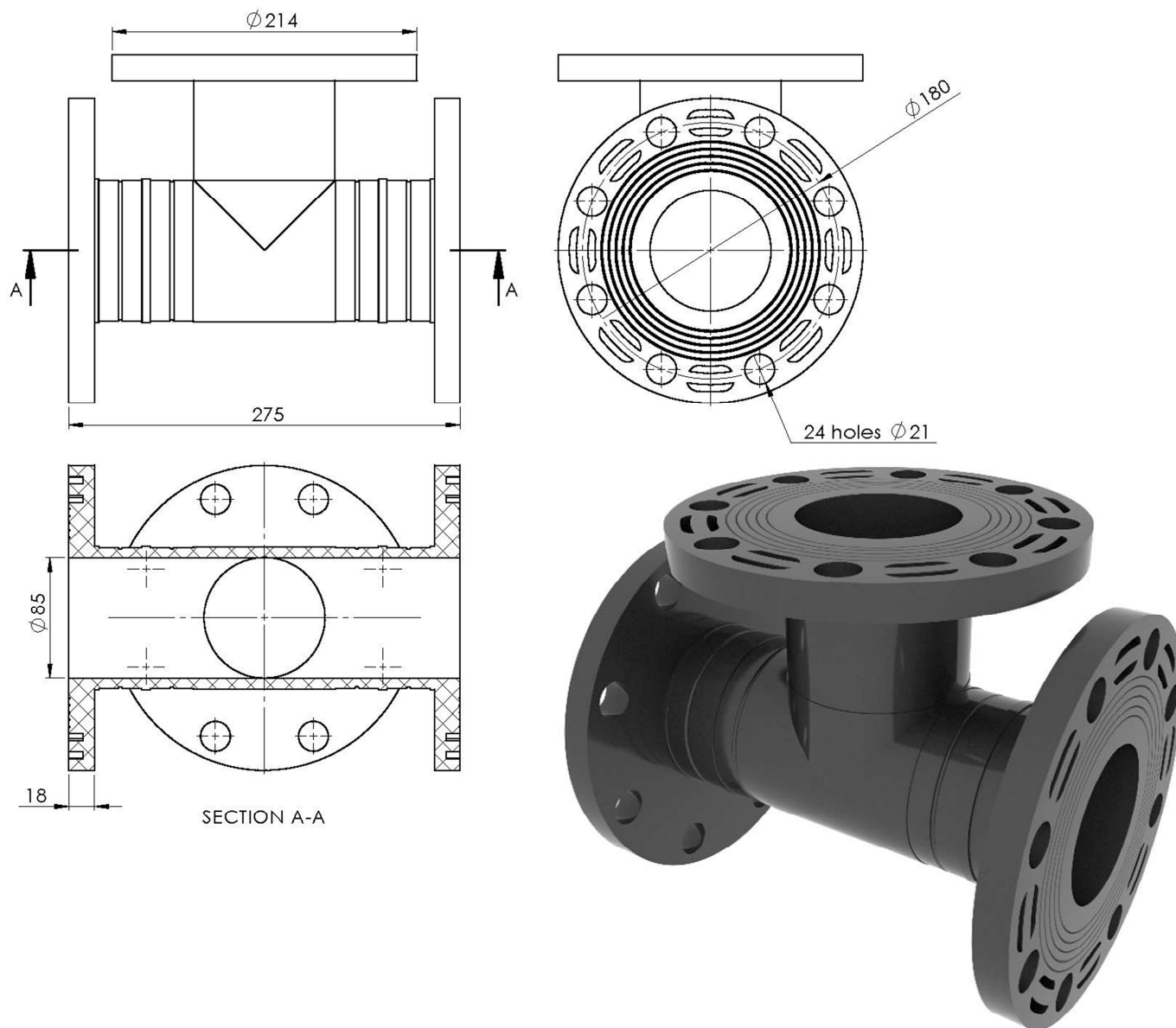
FORWARD FIT Flanged tee 4"

Basic element of the connection unit. Flanges 4" let the element connect to the existing pipeline or to another *FORWARD FIT* fitting. Any type of wafer shut-off valves 4" is allowed.

Material:	glass-filled polyamide
Operating pressure limit:	40 kg/cm ²
Operating pressure:	15 kg/cm ²

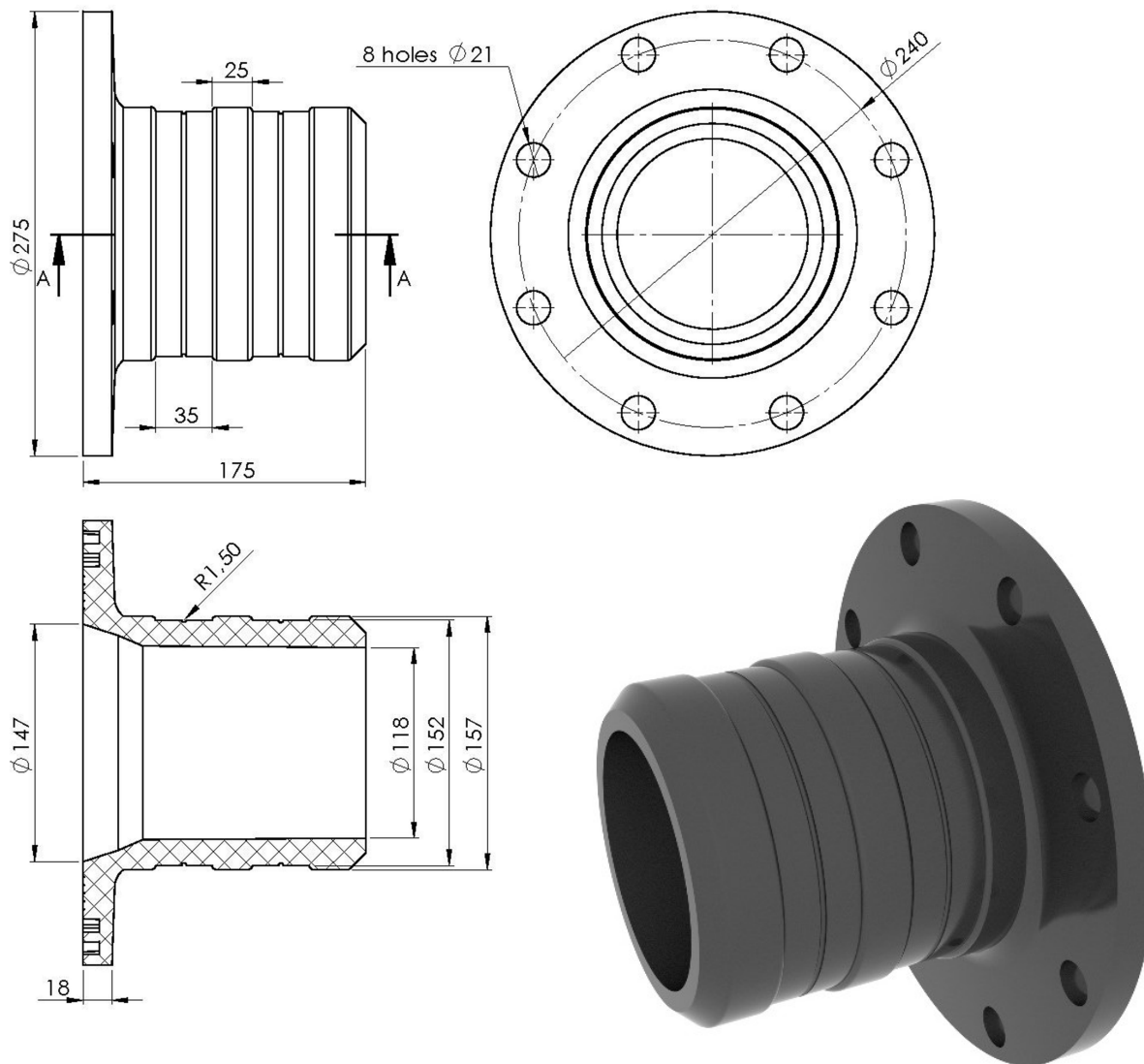
FORWARD FIT Flange 6" with barb 6"

Basic element of the connection unit. Provides flexible pipeline connection. The barb part of the element contains O-rings grooves. Flanges 6" let the element connect to the existing pipeline or to another *FORWARD FIT* fitting. Any type of wafer shut-off valves 6" is allowed.

Material:	glass-filled polyamide
Operating pressure limit:	40 kg/cm ²
Operating pressure:	15 kg/cm ²

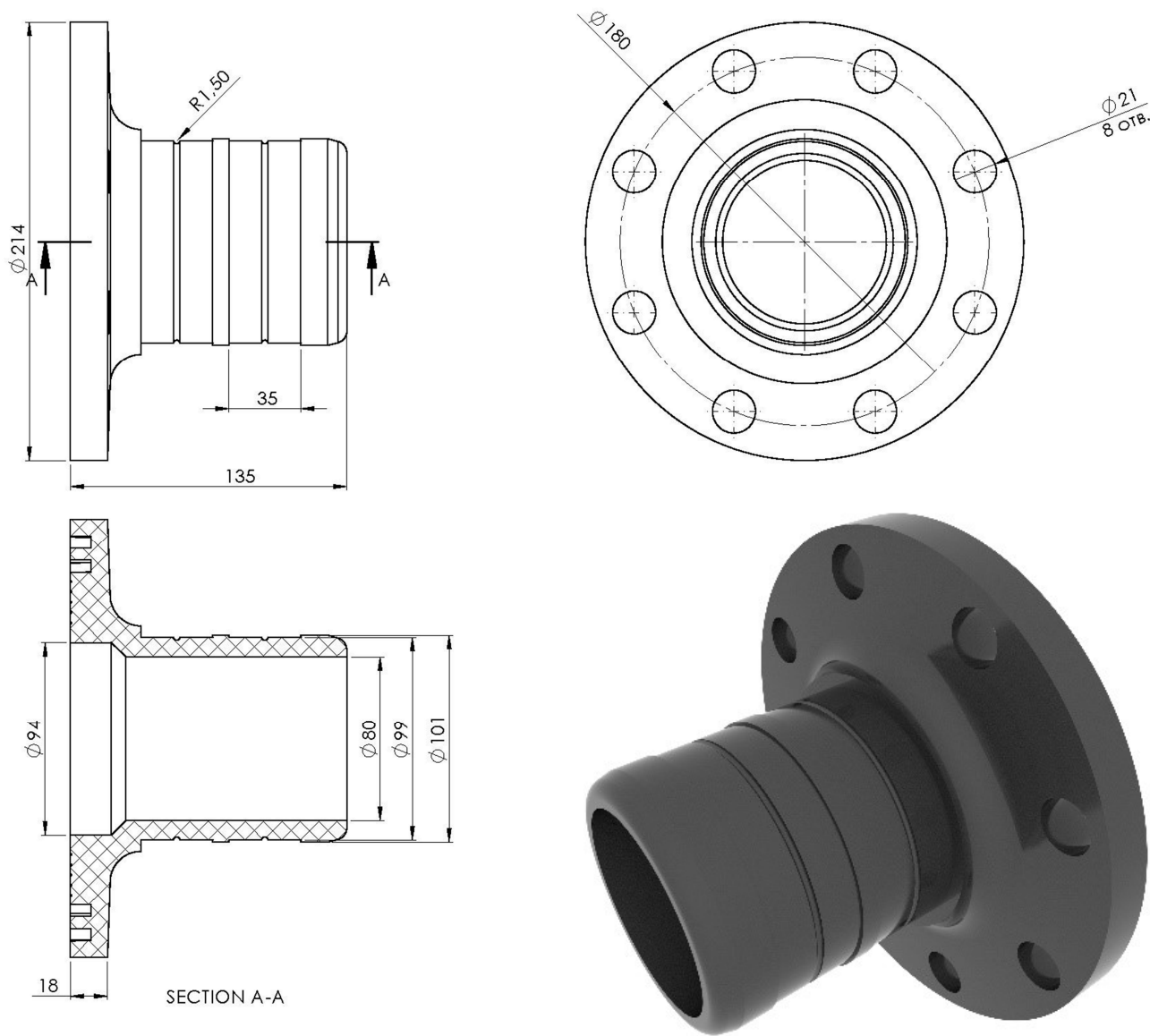
FORWARD FIT Flange 4" with barb 4"

Basic element of the connection unit. Provides flexible pipeline connection. The barb part of the element contains O-rings grooves. The barb part diameter can be changed to required one at the customer's request. Flanges 4" let the element connect to the existing pipeline or to another *FORWARD FIT* fitting. Any type of wafer shut-off valves 4" is allowed.

Material:	glass-filled polyamide
Operating pressure limit:	40 kg/cm ²
Operating pressure:	15 kg/cm ²

FWD FIT

FORWARD FIT Barb 6" & Barb 4"

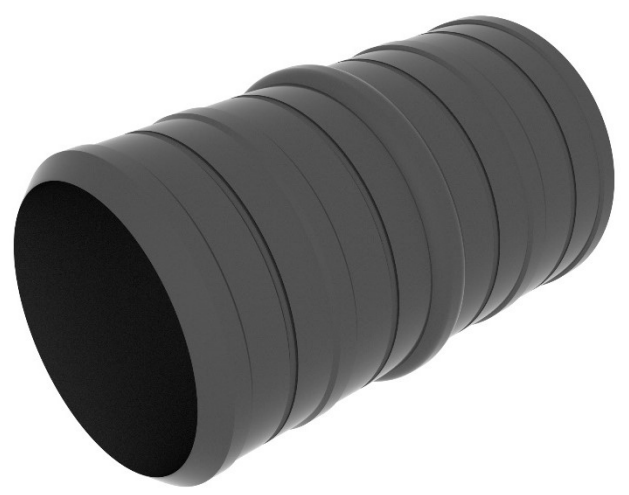
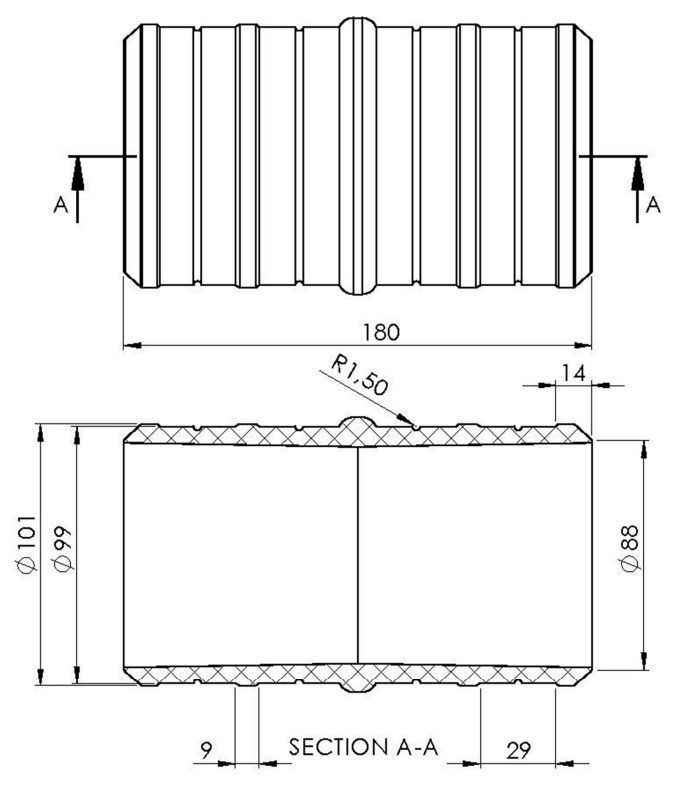
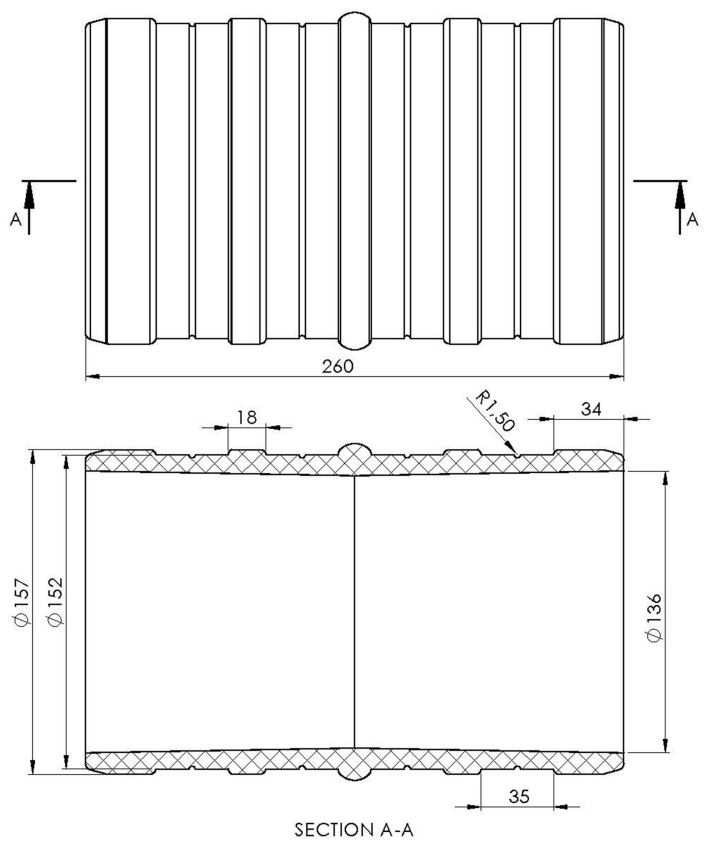

Flexible pipelines' connection element. The barb parts of the elements contain O-rings grooves. The barb part diameter can be changed to required one at the customer's request.

Material:	glass-filled polyamide
Operating pressure limit:	40 kg/cm ²
Operating pressure:	15 kg/cm ²

FORWARD FIT Threaded flange 4" for pressure regulator 4"

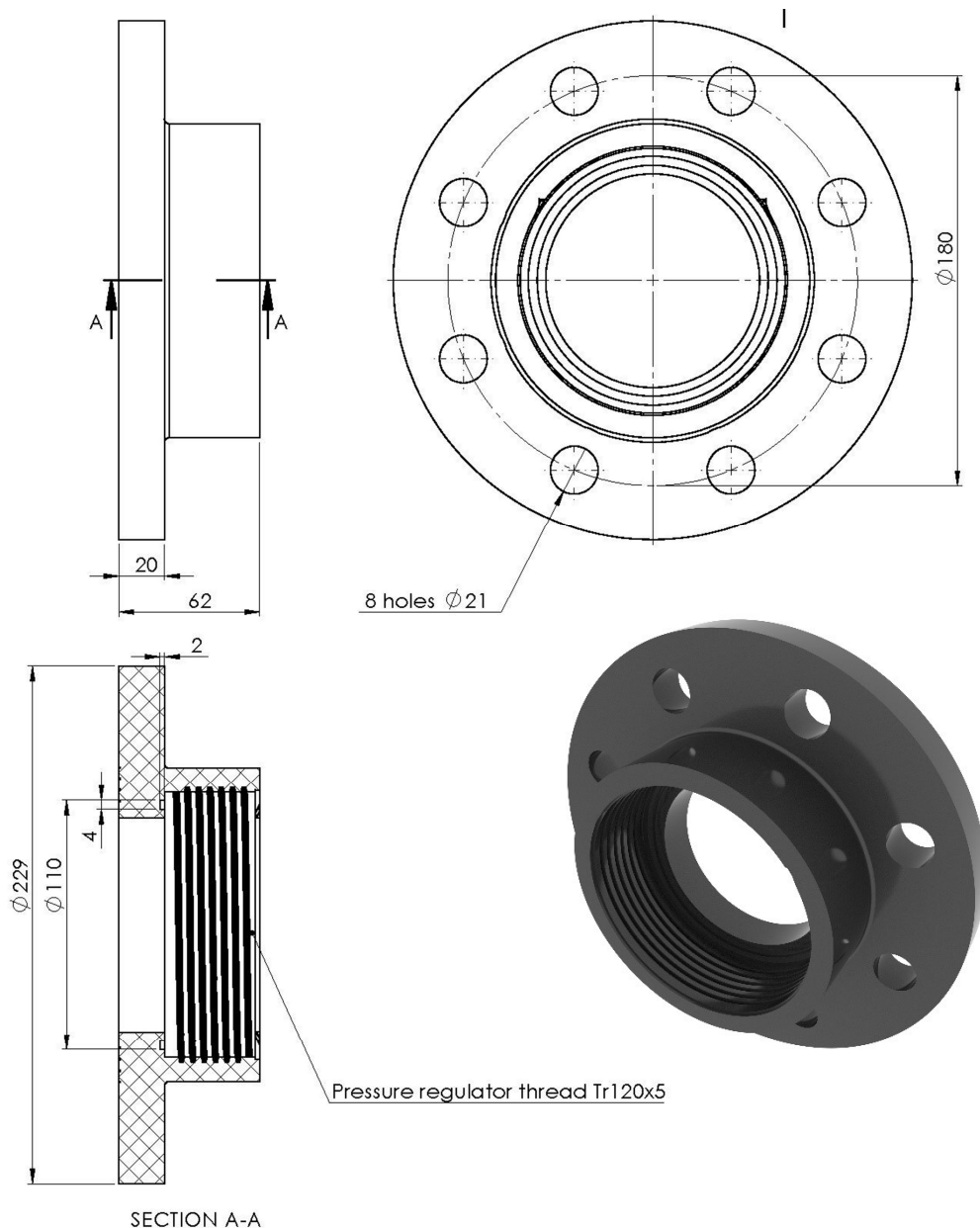

Basic element of the connection unit. Provides pressure regulator 4" connection. Flanges 4" let the element connect to the existing pipeline or to another *FORWARD FIT* fitting. Any type of wafer shut-off valves 4" is allowed.

Material:	glass-filled polyamide
Operating pressure limit:	40 kg/cm ²
Operating pressure:	15 kg/cm ²

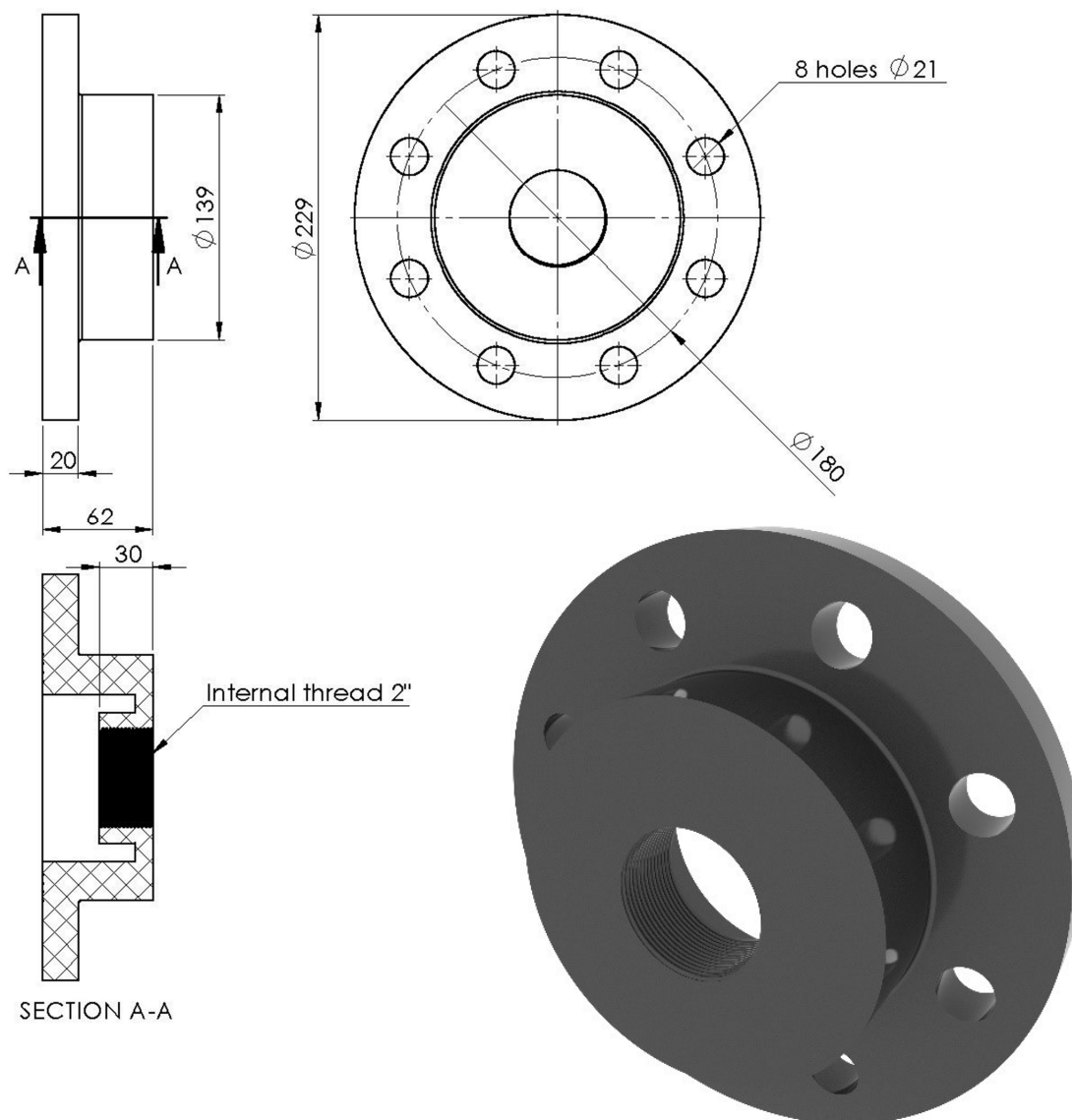
FORWARD FIT Threaded flange 4"

Basic element of the connection unit. Provides any thread 2" elements connection. The thread part diameter can be changed to required one at the customer's request. Flanges 4" let the element connect to the existing pipeline or to another *FORWARD FIT* fitting. Any type of wafer shut-off valves 4" is allowed.

Material:	glass-filled polyamide
Operating pressure limit:	40 kg/cm ²
Operating pressure:	15 kg/cm ²

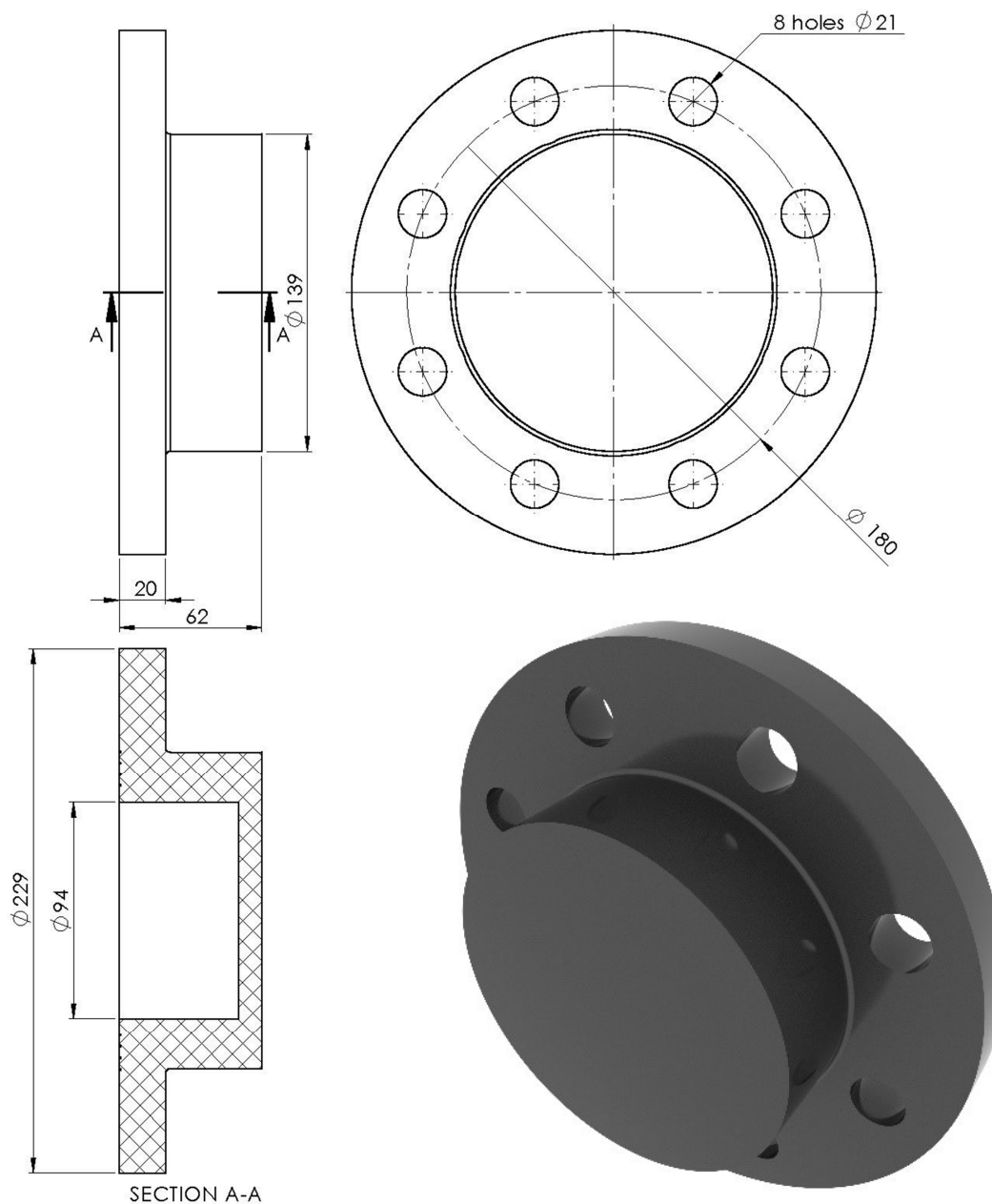
FORWARD FIT Blind flange 4"

Basic element of the connection unit. Provides the temporarily plugging of the pipeline. Flanges 4" let the element connect to the existing pipeline or to another *FORWARD FIT* fitting. Any type of wafer shut-off valves 4" is allowed.

Material:	glass-filled polyamide
Operating pressure limit:	40 kg/cm ²
Operating pressure:	15 kg/cm ²

FORWARD FIT Rubber products for flanges 6" and 4"

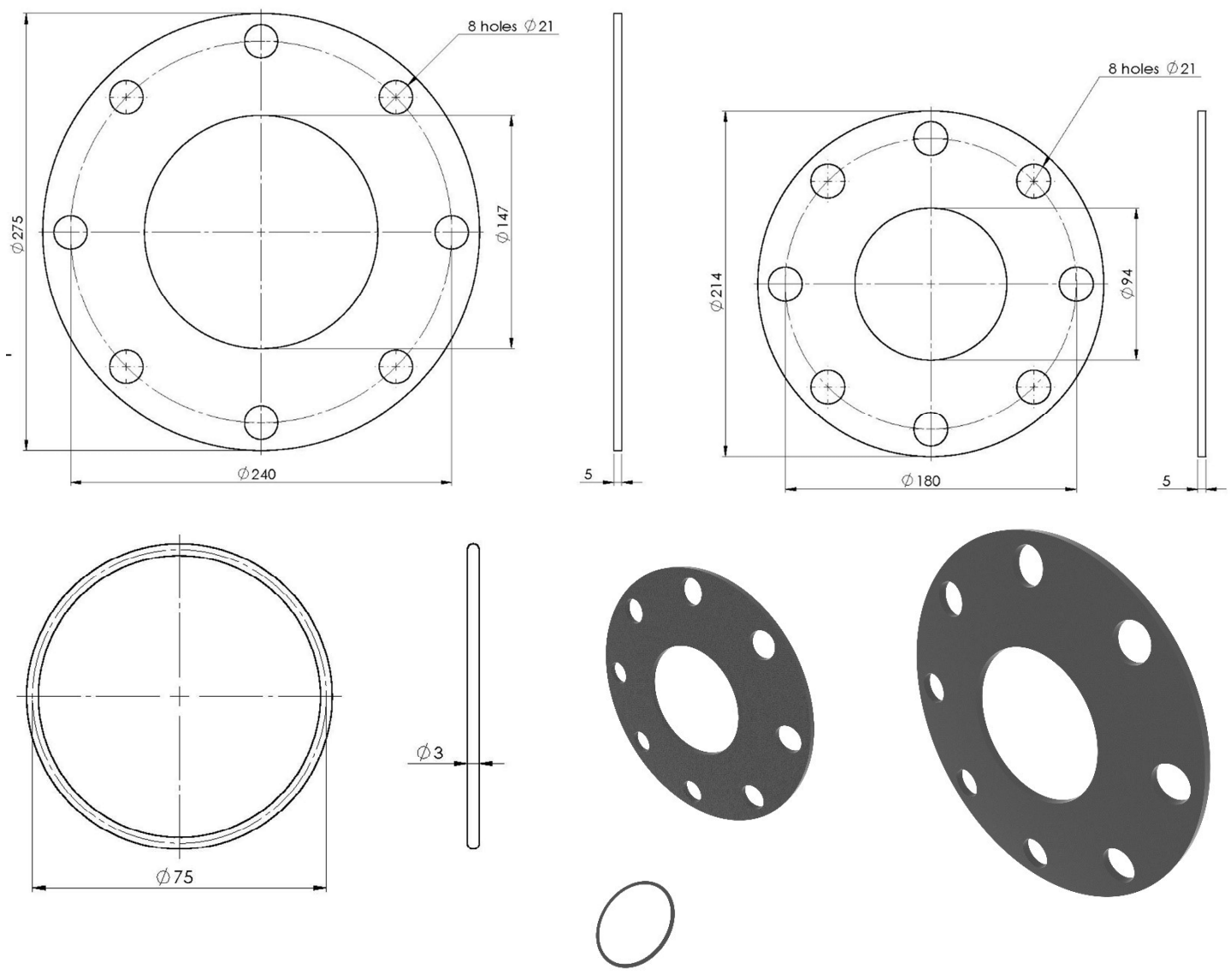

Rubber gaskets for flanges 6" and 4" are used for the inter-flange sealing of *FORWARD FIT* elements' connections.

O-ring 75x3 mm used for additional sealing of the barb 6" and 4" connections.

Material: rubber

FWD fit

Polyamide fitting manufacture

PRODUCT CATALOG

FORWARD fit

W: <https://fwdfit.com/>

E: info@fwdfit.com

Phone: +38 093 327 6430

Telegram: +38 093 327 6430

Odessa